

The Grapevine

Volume IV

The Official Newsletter of El Pueblo de Los Angeles Historical Monument

Dec. 2012

VISIT US ON FACEBOOK AND TWITTER

In November, El Pueblo Historical Monument launched our Facebook page at www.facebook.com/ElPuebloLA.

Our Twitter feed is [@ElPuebloLA](https://twitter.com/ElPuebloLA).

We intend to use these social media outlets to improve the marketing of our special events, regularly highlight the Olvera Street merchants, showcase our museums, as well as to inform the public of our important history and partnerships with numerous organizations and individuals throughout Southern California and beyond.

MERCHANT OFFICE HOURS

To increase the General Manager's availability to our merchant partners, we have standing office hours every Wednesday from 3 pm to 5 pm. Please call (213) 485-6855 or e-mail Linda Duran at Linda.Duran@lacity.org to make an appointment.

El Pueblo
de
Los Angeles

IMPROVING PEDESTRIAN LINKAGES

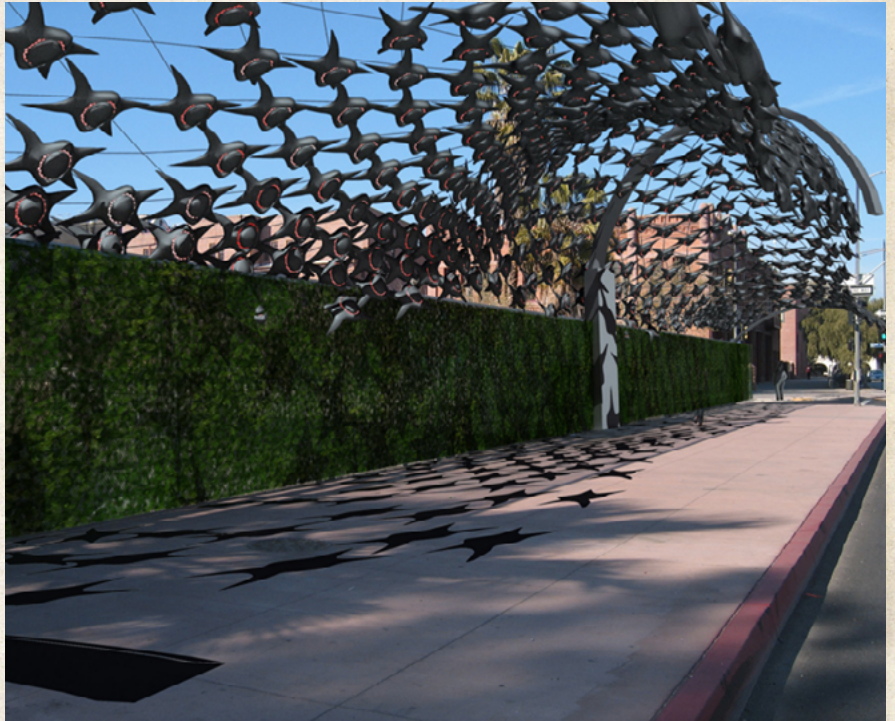

When walking south across the 101 Freeway overpass on both Los Angeles and Main Streets, you will encounter a series of green construction fences. It might appear a bit unsightly now, but when this \$2 million construction effort is completed in the first quarter of 2013, you will experience the convergence of architecture, art and the creative use of public space.

Bridging Flows is a pedestrian enhancement project by infranatural + Ned Kahn. Both Los Angeles and Main Street will have an arching trellis of connected nodes that will provide shade during the day, and light in the evening as each node is equipped with an LED light fixture. Each arching trellis will create a visual and physical connection between El Pueblo Historical Monument and the Civic Center, particularly City Hall and the new Grand Park. *Bridging Flows* is the last major component of a series of Metro Call for Projects that included street resurfacing and the widening of the sidewalks across the 101 Freeway.



A GREAT SUCCESS!

The 2012 Holiday Season Lighting Ceremony was an incredible success as noted by our participants, merchants, visitors, family, and friends. The great atmosphere and holiday spirit was alive and well – even the rain stopped in time for the performances, recognizing that El Pueblo Historical Monument is truly a blessed neighborhood.

Our appreciation to our hard working colleagues:

Jessica Herrera, Linda Duran, Eric Jimenez, John Mosquera, Nicholas Hopper, and Jaime Chavez.

Our best holiday wishes to:

Tournament of Roses Queen Vanessa Natalie Manjarrez and Court members Madison Teodo, Sonia Sheno, Kate Benuska, Nicole Nelam, Tracy Cresta, Victoria McGregor.

Thanks to our entertainers!

Walnut HS Women's Ensemble, Grupo Folklorico Antelope Valley, Mariachis Divas, Esperanza HS Choir, Ballet CoCo, Mark Keppel HS "Aztec Singers", Plaza de la Raza Youth Mariachi Ensemble, Saugus HS Concert Choir, and Breanna Beltran.

Thank you to our generous sponsors!

Ice Age – Continental Drift, Linda Mejia from Wells Fargo Home Mortgage, AAA Rentals, Clear Image Printing, Tamales Lilianas, Urth Café, La Parilla Restaurant, Starbucks, Subway, the Olvera Street Merchants, and the El Pueblo Park Association.

NEW EXHIBIT AT THE CHINESE AMERICAN MUSEUM

On December 13, 2012, the Chinese American Museum is opening a new, permanent exhibition. *Origins: The Birth and Rise of Chinese American Communities in Los Angeles* will profile and create the context for understanding the communities of Historic Chinatown, New Chinatown, and Monterey Park. The exhibit will highlight the rich cultural legacy and continuing contributions of Chinese Americans in Los Angeles. In addition, the museum is launching *Origins Online*, an interactive web site (orgins.camla.org) that facilitates further exploration of emerging new communities in the San Gabriel Valley and other Los Angeles locales.

The completion of *Origins* marks the first addition to the permanent galleries since the museum opened in 2003. Many community members researched and collected photographs and artifacts connecting these neighborhoods into one continuum of Chinese American history.

CHRISTOPHER P. ESPINOSA
General Manager

125 PASEO DE LA PLAZA, SUITE 400
Tel: (213) 485-6855

Web: www.elpueblo.lacity.org

 www.facebook.com/ElPuebloLA

